

# WHAT'S NEW IN SOLIDWORKS 2017



## 1 SOLIDWORKS 3D INTERCONNECT

- Open proprietary 3D CAD data directly into SOLIDWORKS including Creo®, CATIA® V5, SolidEdge®, NX™, and Inventor® and retain associativity to the original file

### Benefits

Work seamlessly with anyone, and incorporate design changes dramatically faster.



## 2 IMPROVED LARGE ASSEMBLY PERFORMANCE

- New Asset Publisher, Ground Mates and Magnetic Mates speed equipment layouts
- Replace sub-assembly with multi-body part and maintain downstream references; Replace missing references all at once

### Benefits

Speed design of large assemblies and layouts machinery and equipment.



## 3 MORE POWERFUL MODELING TOOLS

- New Advanced Hole Wizard creates/reuses customized holes
- Wrap Feature now for any surface; Offset 3D Curve on surface with multiple faces
- Sheet Metal support for three-bend corners

### Benefits

Faster, easier modeling with fewer picks and clicks.



## 4 RENDERINGS AND ANIMATIONS GET A BOOST FROM VISUALIZE

- New "Visualize Boost": Network rendering made simple for blazing fast render speeds
- Import animations and motion studies
- Map SOLIDWORKS camera navigation and hot keys
- Support for HTC® Vive™, Oculus, Google® Cardboard, Samsung®

### Benefits

Dramatic improvement in rendering speed and improved workflow between modeling, rendering, and viewing.

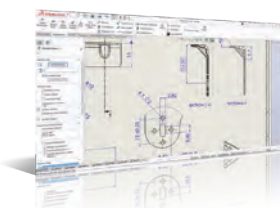

## 5 FASTER 2D DRAWING CREATION

- Reference and link to BOM table cell elements in annotations
- Parametrically mirror drawing views without the model
- Pre-defined layers

### Benefits

Simplified, faster drawing creation.

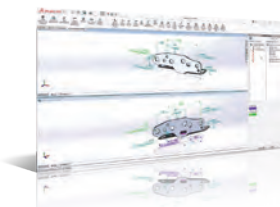

## 6 EXPANDED CAPABILITIES FOR MODEL BASED DEFINITION

- Compare geometry and 3D PMI between two revisions
- Define DimXpert 3D PMI more easily for drafted parts
- Export STEP 242 with 3D PMI to automate CAM and CMM
- Attach multiple files to 3D PDF to build Technical Data Packages (TDP)

### Benefits

Ease the transition from 2D drawings to MBD and enable model-based enterprises (MBE).



## 7 ELECTRIFYING ELECTRICAL/ELECTRONIC DESIGN

- Electrical: Automatic creation of schematic from a spreadsheet
- Electrical: Compound parts – accessories
- PCB: Unified design environment between schematic editing, board layout and 3D layout

### Benefits

Expanded capabilities mean improved productivity for electrical design.

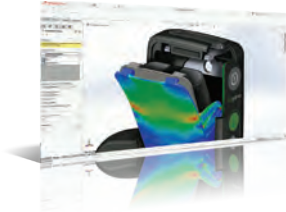

## 8 SIMPLIFYING DESIGN VALIDATION

- Simulation: Display simulation results in SOLIDWORKS model; arc length control for nonlinear contact
- Plastics: Part Mass can be used in addition to gate temperature for gate freeze and pressure holding time determination
- Flow: Parametric Study now allows multi-parameter optimization

### Benefits

Simulation expanded to handle more use cases – extended capabilities tackle more design scenarios.



## 9 INTEGRATING DESIGN AND MANUFACTURING

- 3D Printing: Import/Export 3MF. Import mesh data
- Inspection: Manual and selective ballooning
- Costing: Instant estimates from manufacturers via My.SolidWorks Manufacturing Network

### Benefits

Extending SOLIDWORKS capabilities for the manufacturing ecosystem.



## 10 IMPROVED DATA MANAGEMENT AND COLLABORATION

- SOLIDWORKS PDM: Version overwrite; Rollback with references; Improved viewing
- SOLIDWORKS PDM Professional: Vault Database Replication
- eDrawings®: Augmented Reality (AR) for the Android™; 3D Views and annotation views for assemblies; Component descriptions; Weld beads; Undo/redo

### Benefits

Collaborate at more levels and manage data more efficiently.

See the full range of SOLIDWORKS software for design, simulation, technical communication, and data management at [www.solidworks.com/products2017](http://www.solidworks.com/products2017).

Our **3DEXPERIENCE®** platform powers our brand applications, serving 12 industries, and provides a rich portfolio of industry solution experiences.

Dassault Systèmes, the **3DEXPERIENCE®** Company, provides business and people with virtual universes to imagine sustainable innovations. Its world-leading solutions transform the way products are designed, produced, and supported. Dassault Systèmes' collaborative solutions foster social innovation, expanding possibilities for the virtual world to improve the real world. The group brings value to over 210,000 customers of all sizes in all industries in more than 140 countries. For more information, visit [www.3ds.com](http://www.3ds.com).



**3DEXPERIENCE®**

**DASSAULT SYSTEMES** | The **3DEXPERIENCE®** Company

**Americas**  
Dassault Systèmes  
175 Wyman Street  
Waltham, Massachusetts  
02451-1223  
USA

**Europe/Middle East/Africa**  
Dassault Systèmes  
10, rue Marcel Dassault  
CS 40501  
78946 Vélizy-Villacoublay Cedex  
France

**Asia-Pacific**  
Dassault Systèmes K.K.  
ThinkPark Tower  
2-1-1 Osaki, Shinagawa-ku,  
Tokyo 141-6020  
Japan

©2016 Dassault Systèmes. All rights reserved. 3DEXPERIENCE®, the Compass icon, the 3DS logo, CATIA, SOLIDWORKS, ENOVIA, DELMIA, SIMULIA, GEOMIA, EXALTERD, 3D VIR, 3DSWYMA, BIOVIA, NETVIBES, IFWE and 3DEXCITE are commercial trademarks or registered trademarks of Dassault Systèmes, a French "société européenne" (Versailles Commercial Register # B.322.306.440), or its subsidiaries in the United States and/or other countries. All other trademarks are owned by their respective owners. Use of any Dassault Systèmes or its subsidiaries trademarks is subject to their express written approval. MKST0PTDSEING0B16